

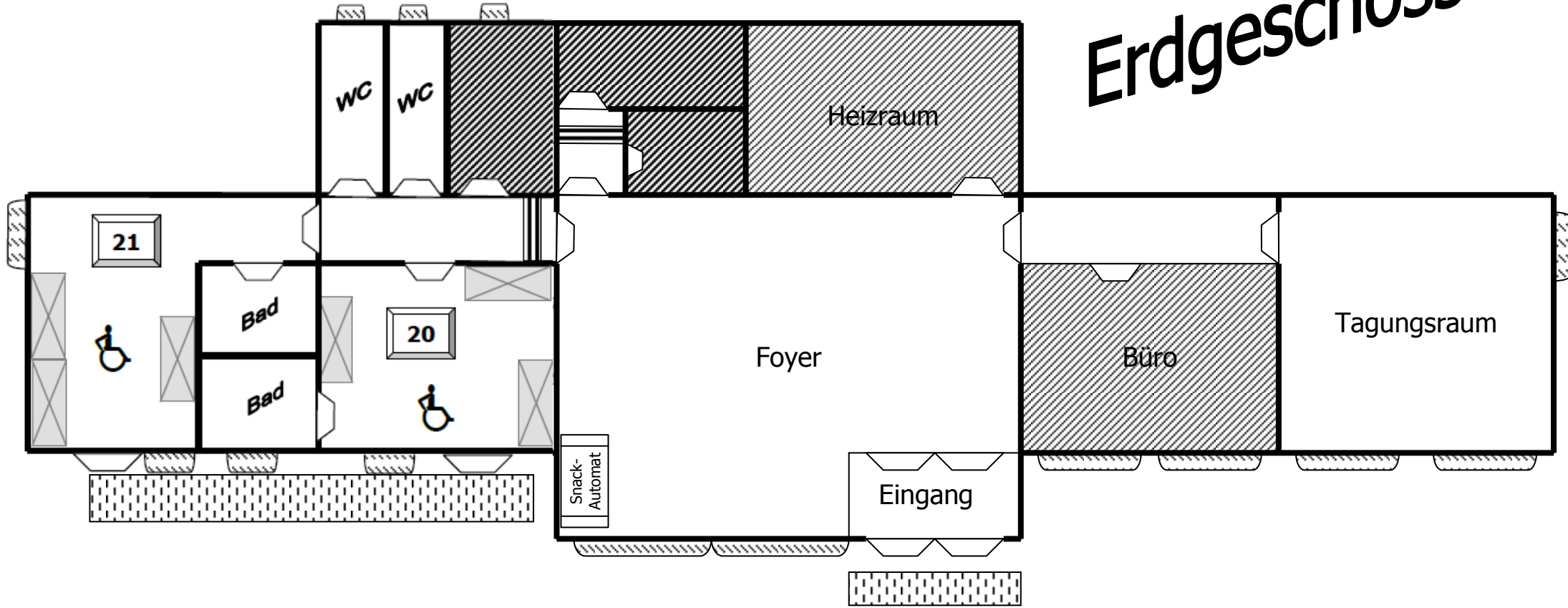

Otto-Riethmüller-Haus

Hausplan - Haus 1

Erdgeschoss



-  Tür
-  Fenster
-  22 Zimmer-Nummer
-  Stockbett
-  Barrierefrei
-  Treppe
-  WC Dusche/Toilette
-  Rampe

Otto-Riethmüller-Haus

Hausplan - Haus 1

Obergeschoss

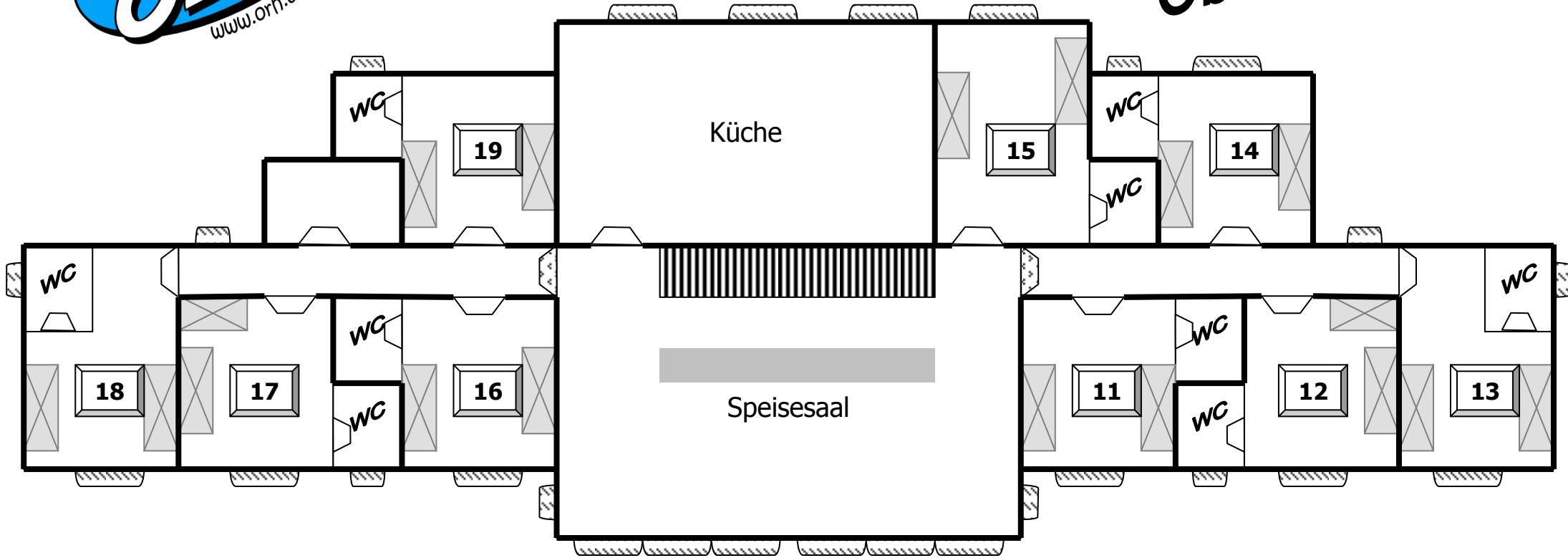

Tür



Fenster



Zimmer-Nummer

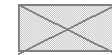

Stockbett



Brandschutztür



Treppe



Dusche/Toilette